

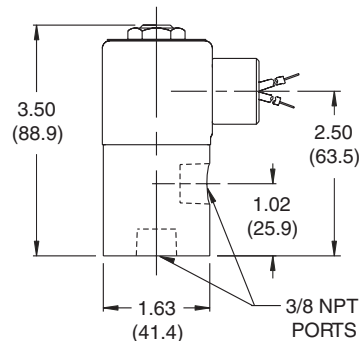

PETER PAUL

SERIES 20 High Flow Low Pressure Model 22T

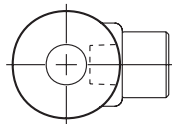
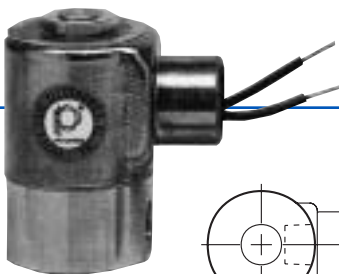

SPECIFICATIONS - OPERATING CONDITIONS

Media: Air and other fluids, compatible with standard Buna seals. Hot water, steam, gasoline, and many oils require special seal materials - Consult factory.

Valve Temperature Range: STANDARD VALVES – 0°F (-18°C) to 104°F (40°C) ambient; 0°F (-18°C) to 150°F (65°C) media. OPTIONAL VALVES – can tolerate much higher or much lower ambient and media temperatures. Consult factory for specifics.

Burst Pressure: Series 20 - 5000 PSI

Leakage: Bubble tight for standard valves

Vacuum: To 15° Mercury

ELECTRICAL CHARACTERISTICS

Coil Voltage: 5 to 825 VAC 50-60 HZ.

Nominal Power: 7.7 Watts AC

Coil Construction: Molded and Non-Molded.

Typical Response Time on Air: 4-16 Milliseconds

MECHANICAL CHARACTERISTICS

Body: Stainless steel

Porting: 3/8" NPT

Housing: Grommet & 1/2 NPT conduit - many options available

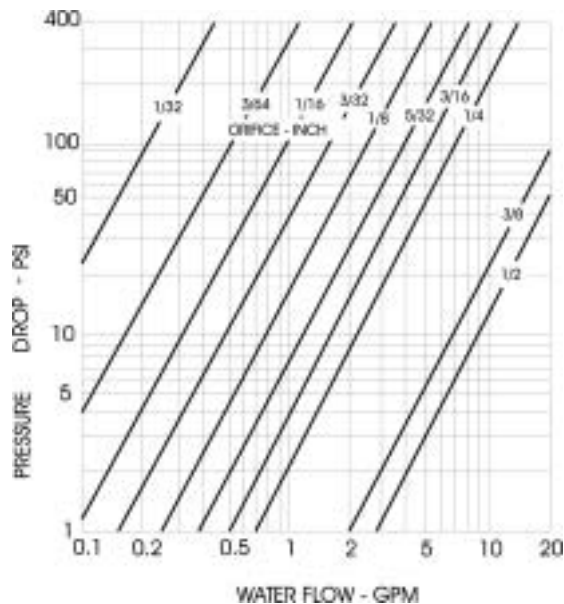

MAX. PRESS DROP P.S.I.	ORIFICE SIZE	CV FACTOR	VALVE NUMBER
AC	3/8	2.0	GROMMET HOUSING 3/8 NPT PIPE PORTS
0 - 10			22T1DGV
or up to			CONDUIT HOUSING 3/8 NPT PIPE PORTS
15° vacuum			22T1DCV

WHEN ORDERING ADD VOLTAGE AND FREQUENCY TO COMPLETE VALVE NUMBER.

EXAMPLE: (22TDGV-120/60)

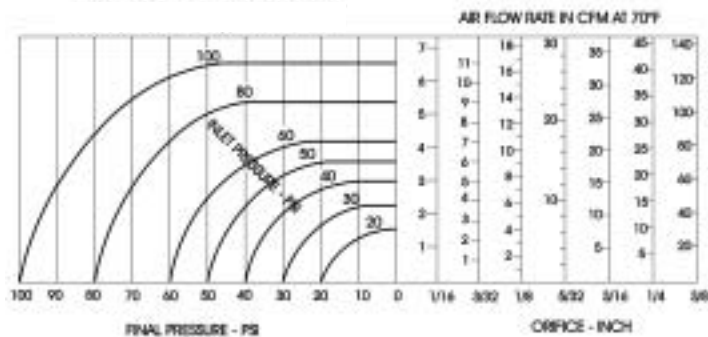

OPTIONS AVAILABLE:

HOUSING OPTIONS *see page 78
STRAIN RELIEF CONNECTOR

SINGLE AUTOMOTIVE

DOUBLE AUTOMOTIVE

“AN” CONNECTOR

MOUNTING BRACKET

COIL OPTIONS *see page 79

MOLDED COIL

POTTED COIL & HOUSING

HIGH TEMPERATURE MOLDED COIL

MISCELLANEOUS OPTIONS see page 76

SILVER SHADING RING

ALUMINUM SHADING RING

Note: Availability of certain options or combination of options may vary with quantity of units ordered - Consult representative or factory