

PETER PAUL

SERIES 20 MODEL H22 & EH22 2-WAY NORMALLY CLOSED HIGH PRESSURE IMPACT TYPE SOLENOID VALVE

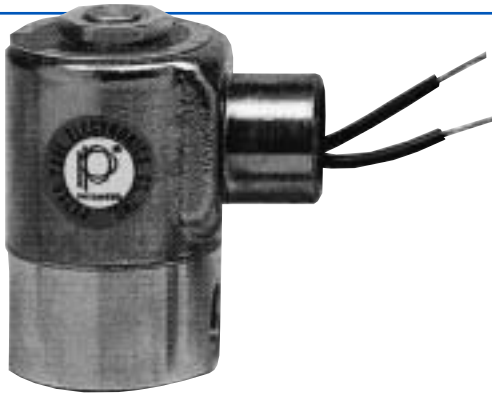

H22



EH22

EXCLUSIVE FEATURES INCLUDE:

A precision stainless steel PLUNGER that supplies the necessary impact force to energize valve.

A Kel-F® PIN† which functions as a sealing element, that is carefully machined for maximum concentricity and fine finish.

The ORIFICE GUIDE is one piece, for near perfect alignment. This means bubble-tight sealing from low pressures right up to maximum pressure rating with the bonus of longer life. The one piece Orifice/Guide can be pressed into almost any standard cavity making it available as an operator for special customer installations.

† Other pin materials available. consult factory

PATENTED

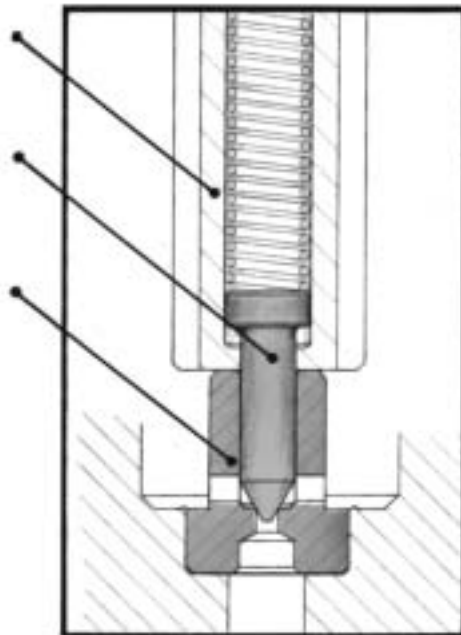

OTHER FEATURES INCLUDE:

Simple construction...

Only 2 moving parts

Available in both standard and explosion proof construction

1/8 or 1/4 NPT ports

PRINCIPLES OF OPERATION

When the valve coil is energized, the plunger is drawn towards the sleeve end stop. The plunger is allowed to accelerate freely for a short distance before it makes contact with the pin shoulder. Upon contact it imparts considerable force on the pin causing it to lift off the seat. A return spring provides the return force, directly on the pin, to seal the orifice when the coil is de-energized.

OPTIONS AVAILABLE: – 2 WAY NORMALLY CLOSED HI-PRESSURE VALVE

HOUSING OPTIONS* see page 78

*STRAIN RELIEF CONNECTOR

*SINGLE AUTOMOTIVE

*DOUBLE AUTOMOTIVE

* "AN" CONNECTOR

MOUNTING BRACKET

COIL OPTIONS – see page 79

MOLDED COIL

POTTED COIL & HOUSING

MISCELLANEOUS OPTIONS – see page 76

HIGH TEMPERATURE MOLDED COIL

SILVER SHADING RING

ALUMINUM SHADING RING

Note: Availability of certain options or combination of options may vary with quantity of units ordered- Consult representative or factory.

*Not available with explosion proof housing

Note: When ordering, add voltage and frequency to complete valve number (Example H22G7DCV—120/60)
To order operator only, add "O" as prefix to valve number (Example OH22GADGV—120/60)

SERIES 20 MODEL H22 2-WAY NORMALLY CLOSED-HIGH PRESSURE									
GAS PRESSURE RATINGS*		ORIFICE SIZE	CV FACTOR	VALVE NUMBER					
AC	DC			GROMMET		CONDUIT		EXPLOSION PROOF	
				1/8 NPT	1/4NPT	1/8 NPT	1/4 NPT	1/8 NPT	1/4 NPT
3000	3000	1/32	.022	H22G7DGV	H22G9DGV	H22G7DCV	H22G9DCV	EH22G7DCCM	EH22G9DCCM
2500	1500	3/64	.041	H22H7DGVG	H22H9DGVG	H22H7DCVG	H22H9DCVG	EH22H7DCCMG	EH22H9DCCMG
1750	500	1/16	.065	H22J7DGVG	H22J9DGVG	H22J7DCVG	H22J9DCVG	EH22J7DCCMG	EH22J9DCCMG
650	100	3/32	.100	H22K7DGVG	H22K9DGVG	H22K7DCVG	H22K9DCVG	EH22K7DCCMG	EH22K9DCCMG

LIQUID PRESSURE RATINGS*		ORIFICE SIZE	CV FACTOR	VALVE NUMBER					
AC	DC			GROMMET		CONDUIT		EXPLOSION PROOF	
				1/8 NPT	1/4NPT	1/8 NPT	1/4 NPT	1/8 NPT	1/4 NPT
3000	3000	1/32	.022	H22G7DGV	H22G9DGV	H22G7DCV	H22G9DCV	EH22G7DCCM	EH22G9DCCM
1500	1500	3/64	.041	H22H7DGV	H22H9DGV	H22H7DCV	H22H9DCV	EH22H7DCCML	EH22H9DCCML
1000	500	1/16	.065	H22J7DGV	H22J9DGV	H22J7DCV	H22J9DCV	EH22J7DCCML	EH22J9DCCML
300	100	3/32	.100	H22K7DGV	H22K9DGV	H22K7DCV	H22K9DCV	EH22K7DCCML	EH22K9DCCML

SPECIFICATIONS

SERIES 20—MODEL H22

Three-way normally closed valve for high pressure applications. Valve must be mounted within 30° of vertical.

OPERATING CONDITIONS

†Media: Air and other non-corrosive gases, water and oil.

Valve Temperature Range: Standard Valve-0°F(-18°C) to 104°F(40°) ambient; 0°F(-18°C) to 150°F(65°C) media. Optional Valves can tolerate much higher or much lower ambient and media temperatures. Consult factory for specifics.

Burst Pressure: 5000 PSI

Maximum Operating Pressure Differential: to 3000 PSI

†To insure trouble free operation, filtration down to 60 microns or less is recommended.

Listings: Valves are U.L. Listed and CSA Certified for Hazardous Locations—Class I, Div 1, Group C and D - Class II, Div 1, Groups E, F, and G; Div 2 Groups A,B,C,D,E,F, and G.

ELECTRICAL CHARACTERISTICS

Coil Voltage: 5 to 825 VAC, 50-60 Hz. 1.8 to 265 VDC

Nominal Power:

H22

EH 22

A.C. 7.7 watts

A.C. 7.3 watts

D.C. 9.5 watts

D.C. 9.5 watts

Coil Construction: Standard valve—molded and non-molded
Explosion Proof valve—molded coil and 3rd wire ground (standard)

Typical Response Time on Air: 4-16 milliseconds

MECHANICAL CHARACTERISTICS

Body: Stainless Steel

Orifice Diameter: 1/32" - 3/32"

Porting: 1/8" and 1/4" NPT

Housing: Standard valve—1/2" NPT conduit and grommet
Explosion Proof valve—1/2" NPT conduit with 3rd Wire Ground (EP only)

STANDARD



GROMMET HOUSING

WT. 1.06 LB.



CONDUIT HOUSING

WT. 1.13 LB.

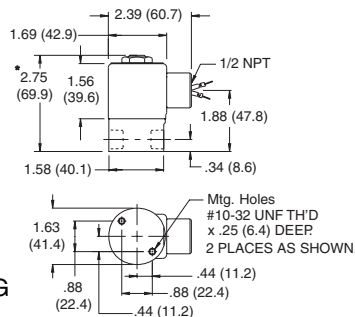

EXPLOSION PROOF

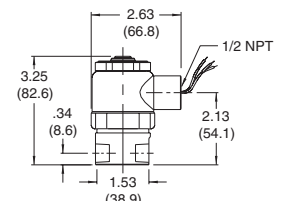

WT. 1.56 LB.

